



RICE CREEK PROFESSIONAL BUILDING

5985 RICE CREEK PARKWAY, SHOREVIEW, MN 55126

- 6,884 SF AVAILABLE
- UP TO 4,354 SF CONTIGUOUS
- GREAT CORNER SPACES
- TWO STORY OFFICE BUILDING WITH ABUNDANT WINDOWS AND 9' CEILING
- JUST EAST OF MEDTRONIC OFFICE PARK
- MONUMENT SIGNAGE AVAILABLE
- EASY ACCESS TO I-35W, I-694, CTY. RD. J, AND US 10
- AREA AMENITIES INCLUDE RESTAURANTS, HOTEL GAS STATION, AND MORE
- OFFICE NET RENT: \$13.00 - \$14.00 SF
- 2025 EST. OPERATING EXP.: \$12.36

CONTACT:

WWW.ESSENCEREALESTATE.COM

JEFF NORDNESS
jeff@essencerealestate.com
(651) 341-5044

RICE CREEK BUSINESS MAP

5985 Rice Creek Parkway, Shoreview, MN 55126

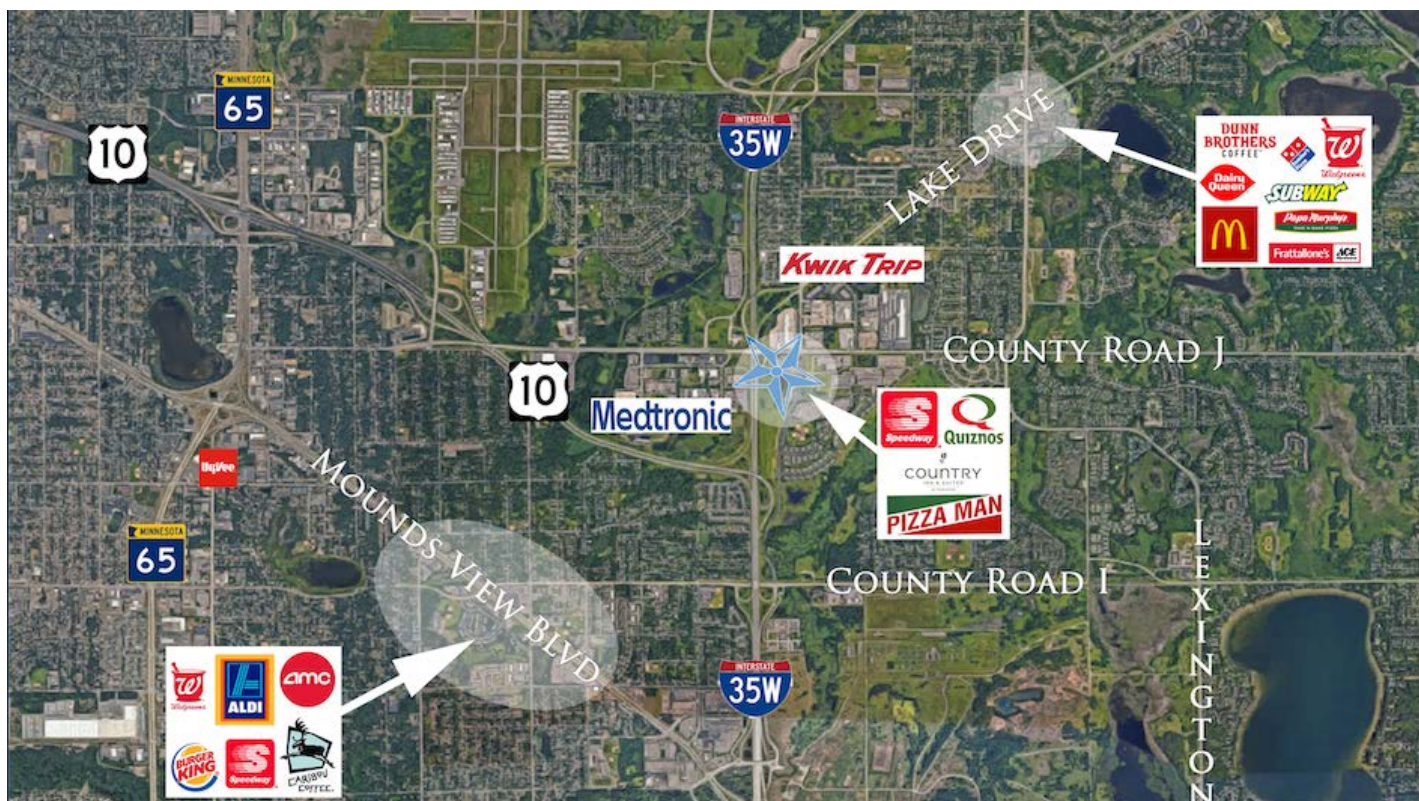

ERSI

ESSENCE
REAL ESTATE
SERVICES, INC.

2 COMMERCIAL REAL ESTATE SINCE 1990

JEFF NORDNESS

jeff@essencerealestate.com

(651) 341-5044

RICE CREEK FLOOR PLAN

5985 Rice Creek Parkway, Shoreview, MN 55126

THE ESTIMATED MONTHLY COST FOR SUITE 201 IS \$5,347.00

THE ESTIMATED MONTHLY COST FOR SUITE 202 IS \$3,724.00

THE ESTIMATED MONTHLY COST FOR SUITE 203 IS \$5,478.00

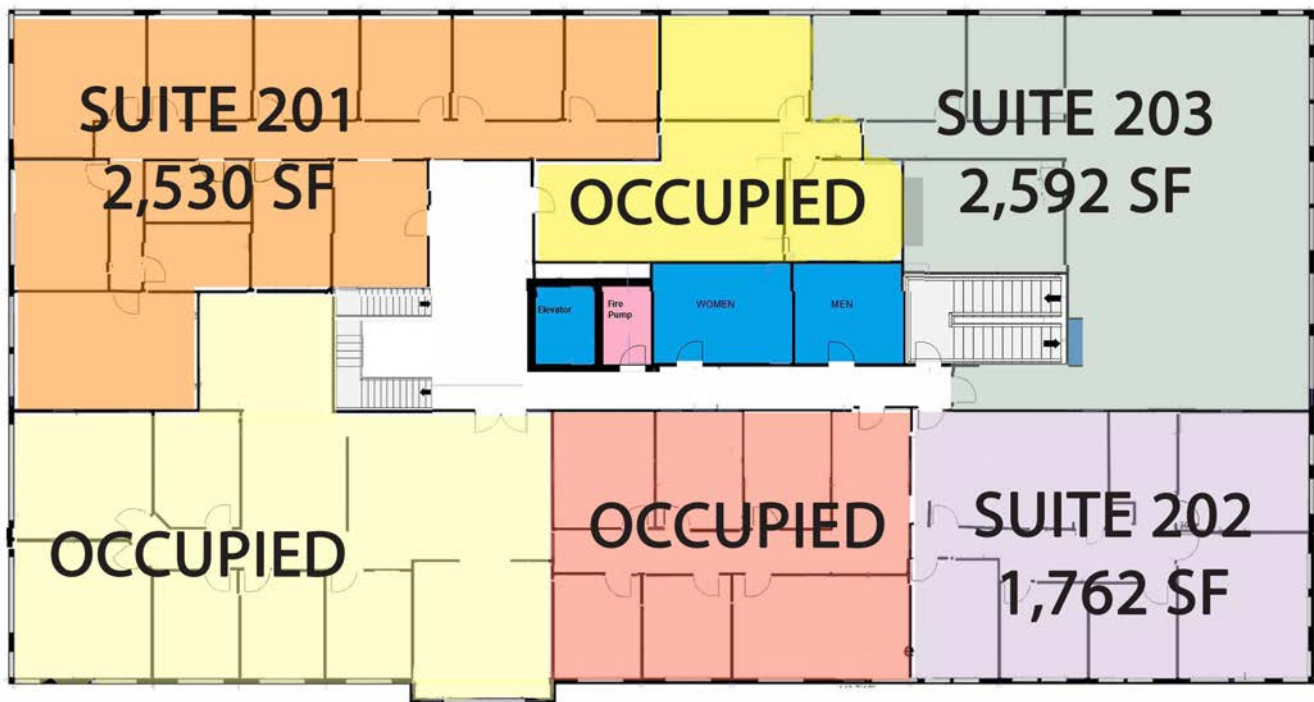

ERSI

ESSENCE
REAL ESTATE
SERVICES, INC.

3 COMMERCIAL REAL ESTATE SINCE 1990

JEFF NORDNESS

jeff@essencerealestate.com

(651) 341-5044