

LAND FOR SALE

4.12 - 30.68
ACRES



CONTACT:

WWW.ESSENCEREALSTATE.COM

JEFF NORDNESS
jeff@essencerealestate.com
651-341-5044

EAST BETHEL LAND

185TH AND HIGHWAY 65 • EAST BETHEL, MN 55011

OVER 1,300 FEET FRONTAGE ON HWY 65

PROPERTY HIGHLIGHTS:

▶ TWO ADJACENT LOTS

Lot A - 4.12 Acres

\$1,076,803.00

2024 Taxes \$4,421.02

PID 32-33-23-31-0006

Lot B - 26.56 Acres

\$997,000.00

2024 Taxes \$7,401.32

PID 32-33-23-31-0008

▶ ZONED HIGHWAY COMMERCIAL (B3)

▶ CITY SEWER AND WATER

▶ PRO DEVELOPMENT CITY

▶ AREA AMENITIES INCLUDE: RESTAURANTS, GAS, BANK, FITNESS, MOVIE THEATER & MORE...

TRAFFIC COUNTS:

STATE HIGHWAY 65 • 31,500 VPD

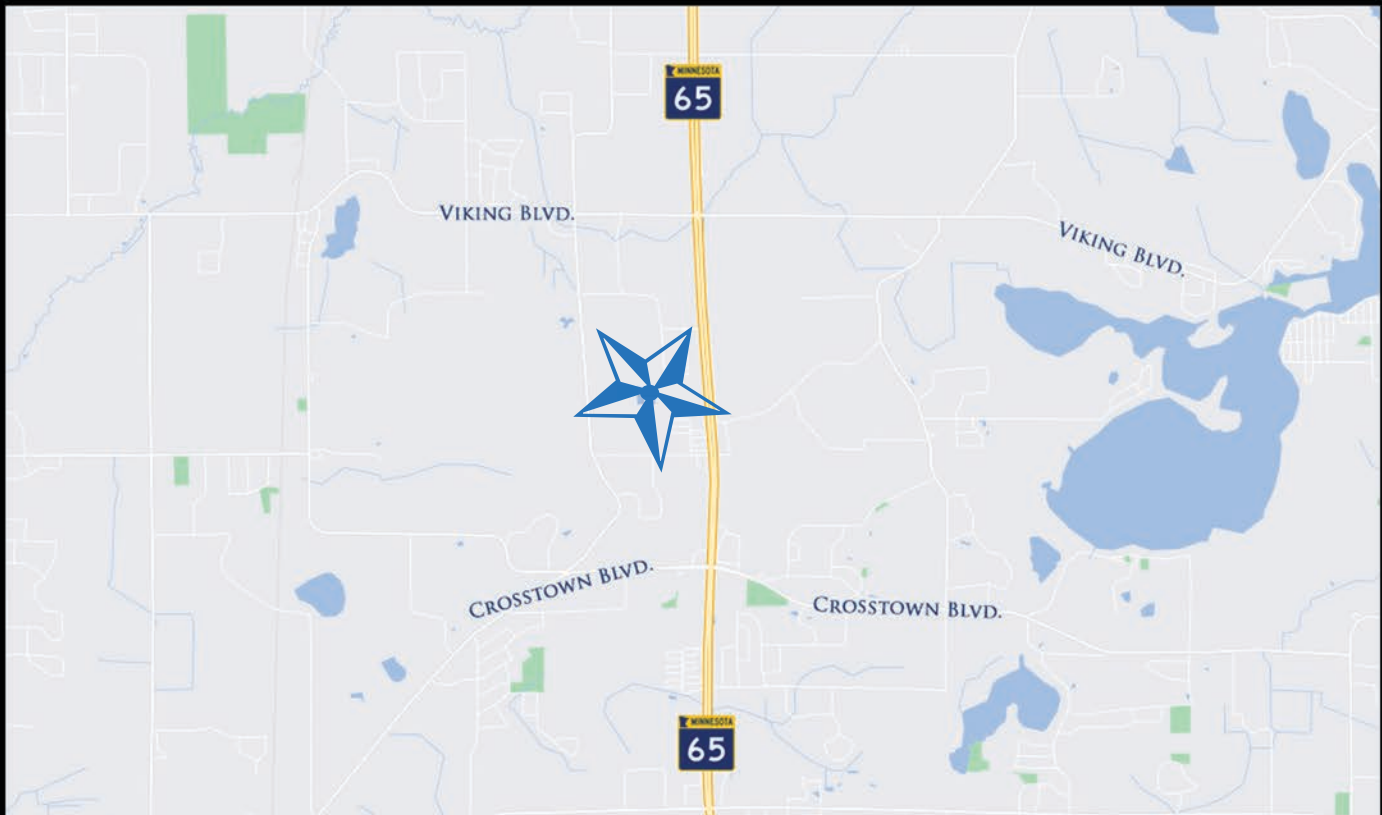

ERSI

ESSENCE
REAL ESTATE
SERVICES INC.

COMMERCIAL REAL ESTATE SINCE 1990

JEFF NORDNESS

651-341-5044

jeff@essencerealestate.com

OFFICE: 651-482-1871

