

# WILLOW LAKE TECHNOLOGY CENTER

3500 WILLOW LAKE BLVD, VADNAIS HEIGHTS, MN 55110

FOR LEASE

GREAT LOCATION FOR YOUR BUSINESS



- 17,218 Square Feet Available Total
- 9,983 Square Feet Office
- 7,235 square feet warehouse
- Office area could be leased separately
- Terrific Access to I694, 35W and Hwy 96
- Prominent glass line with visibility to County Road E
- Easy to find with access directly off of I35E just north of I694
- Fully air conditioned and Sprinkled
- 18'+ clear Heights and two dock doors
- Area amenities including: Festival, Target, Wal-Mart
- Jimmy's Grille & Banquet Exceptional, Holiday Inn Express,
- Comfort Suites, The Vadnais Sports Complex, and other Retail

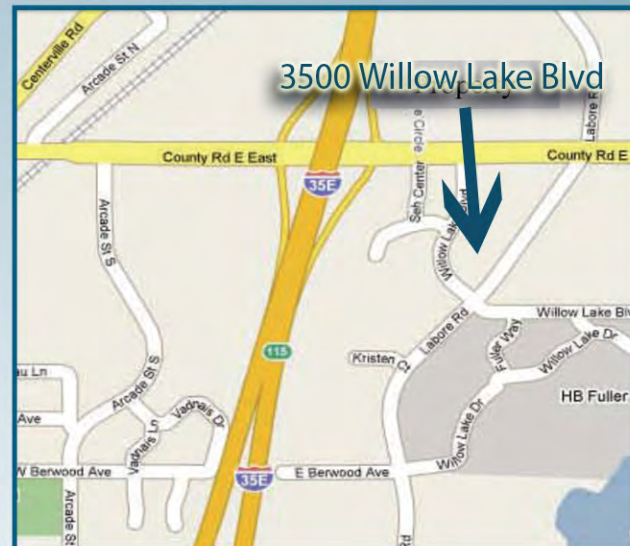

**ERSI**

*ESSENCE  
REAL ESTATE  
SERVICES INC*

**(651) 482-1871**

[www.essencerealestate.com](http://www.essencerealestate.com)

Commercial / Industrial Brokers / Consultants

Information deemed reliable however not guaranteed. Property may be withdrawn from market at anytime without notice.

# WILLOW LAKE TECHNOLOGY CENTER

3500 WILLOW LAKE BLVD, VADNAIS HEIGHTS, MN 55112

FOR LEASE

GREAT LOCATION FOR YOUR BUSINESS

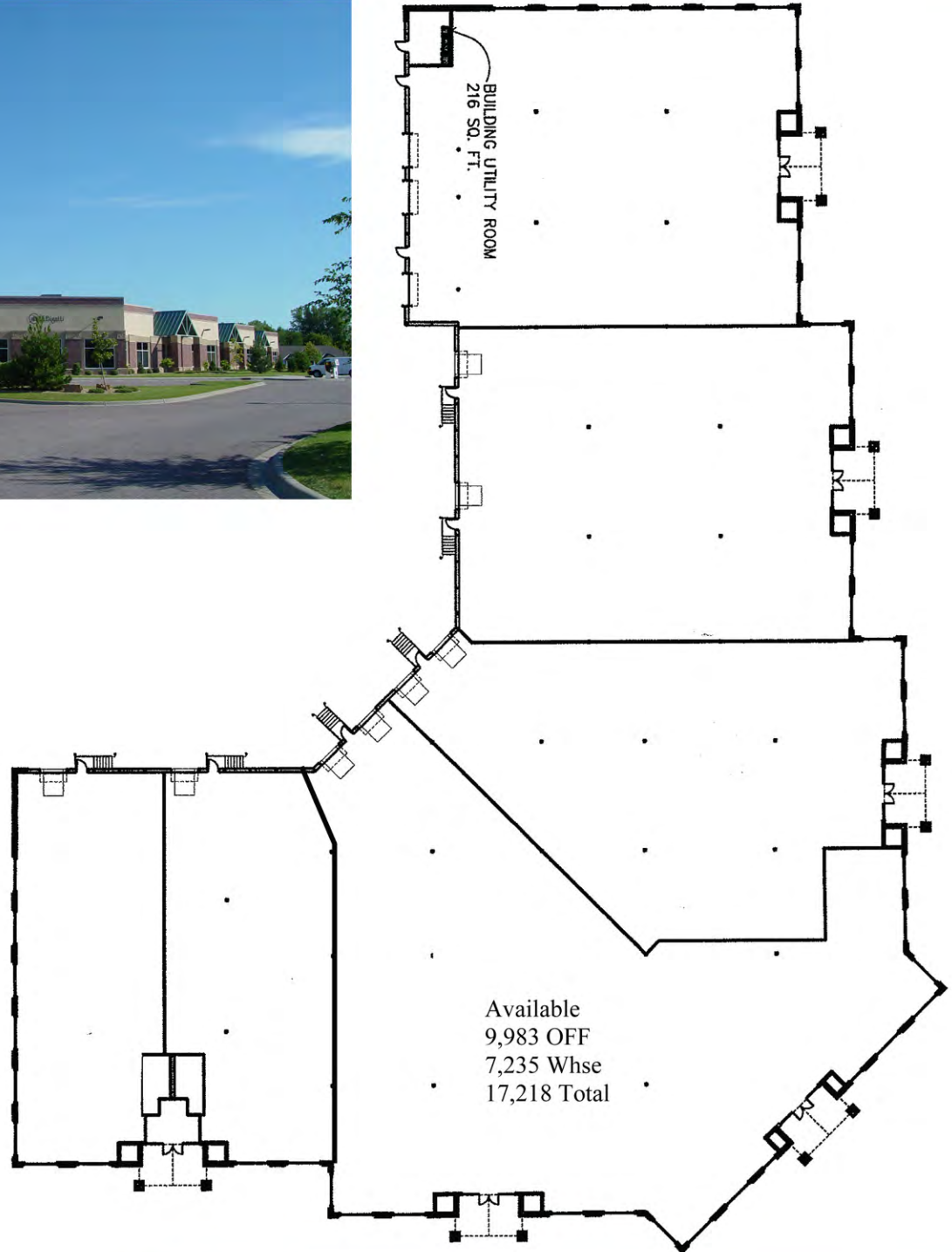

**ERSI**

*ESSENCE  
REAL ESTATE  
SERVICES INC*

**(651) 482-1871**

[www.essencerealestate.com](http://www.essencerealestate.com)

Commercial / Industrial Brokers / Consultants